



Z25 8-BOLT PTO INSTALLATION

RAM TorqueFlite HD/ZF PowerLine Series and PACCAR TX-8 Transmissions

1. Label Placement - The PTO ships with 4 WARNING LABELS. Make sure mounting surfaces are clean before placing labels. Place labels as shown below.

(2)

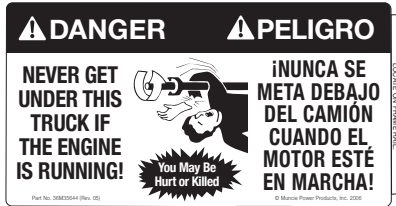

(1) 4" x 6.5"

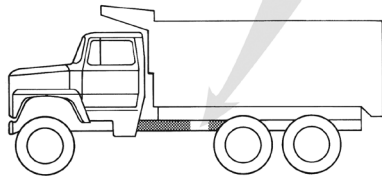

Frame Rail Labels

Place on frame rail or truck body on both sides of vehicle. Must be clearly visible by anyone who might go under truck or near PTO. Clean surface thoroughly before installation.
DO NOT PAINT OVER LABELS

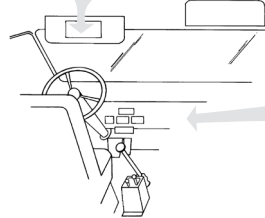

Interior Labels

Place 2" x 3" PTO Equipped Caution label within cab in clear view of operator and near PTO control. Place 4" x 6.5" Visor Label on visor on operator's side of vehicle.
DO NOT COVER ANY VEHICLE AIR BAG WARNING LABEL!

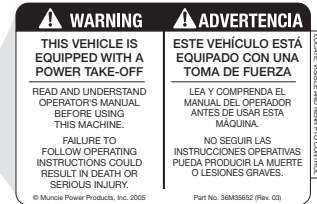

(1) 2" x 3"

2. With PARK brake set, place truck in neutral and start engine. Listen to engine and transmission. Any transmission gear noise may be more noticeable after PTO is installed. **STOP ENGINE. NEVER GO UNDER VEHICLE WITH ENGINE RUNNING!** Find PTO opening on transmission. The drive side PTO for the 4x4 RAM will require an aftermarket transfer case in order to support a driveshaft driven device.

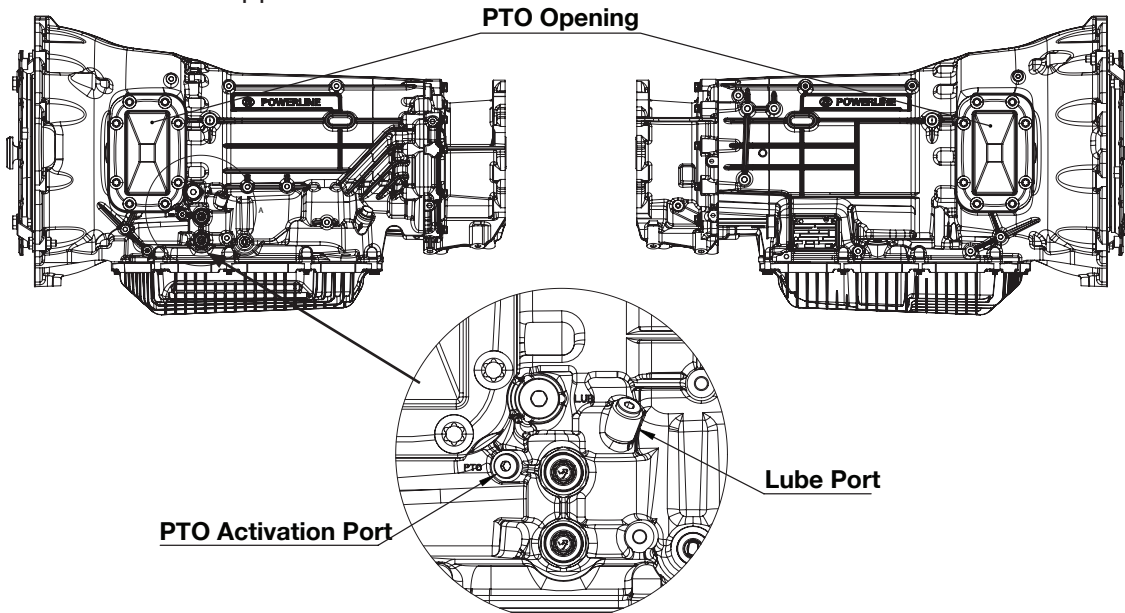

3. Remove transmission cooler lines. These must be removed to allow path for PTO to get to mounting pad. Both lines are held in by spring clips. To remove lines, remove plastic retainer and spring clip, then pull line out of fitting. Take care to not damage clips. They can be reused. Cooler lines can be reinstalled by reversing this process.

4. Remove transmission PTO cover plate and gasket. **Caution:** Some transmission fluid may escape opening. Take care to keep contaminants out of transmission with cover off. Verify PTO gear is present in transmission. Locate the PTO mounting kit. Find alignment pins (2 plcs), and install in the correct location (see below).

PTO cover plate cap screws require an E14 Torx socket for removal

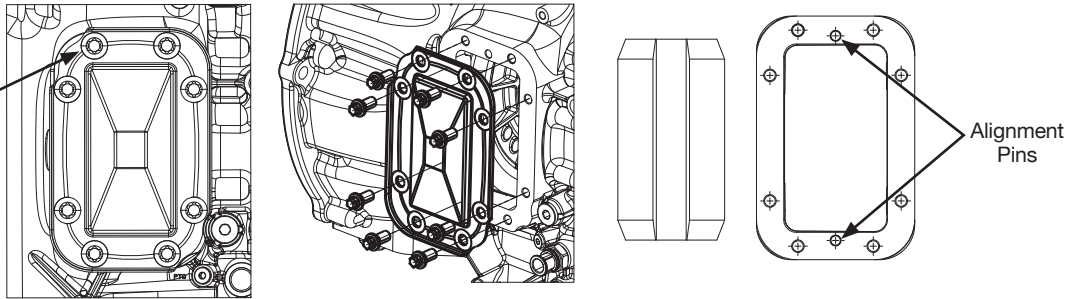

DISCARD FACTORY GASKET

5. Install supplied gasket over alignment pins. A thin coating of approved transmission fluid on gasket is recommended to help hold gasket to opening. Mount PTO with provided cap screws, studs, and nuts. Check for proper PTO fit on transmission prior to tightening down fasteners. PTO mounting surface must be flush against transmission prior to tightening mounting fasteners! Failure to do so may result in damage to PTO housing. Tighten top and bottom cap screws first.

NOTE: All debris and any oil/ transmission fluid be cleaned out of the PTO mounting bolt holes in the transmission, prior to installing the PTO. The patch requires a dry, clean hole for proper function. Failure to clean the bolt holes will result in the patch failing to activate.

Install Following: Gasket (1 pc), 30 mm cap screws, studs and nuts used in remaining positions (7 plcs). **Included fasteners have pre-installed thread locker patches on threads. Use of additional thread locker not required.**

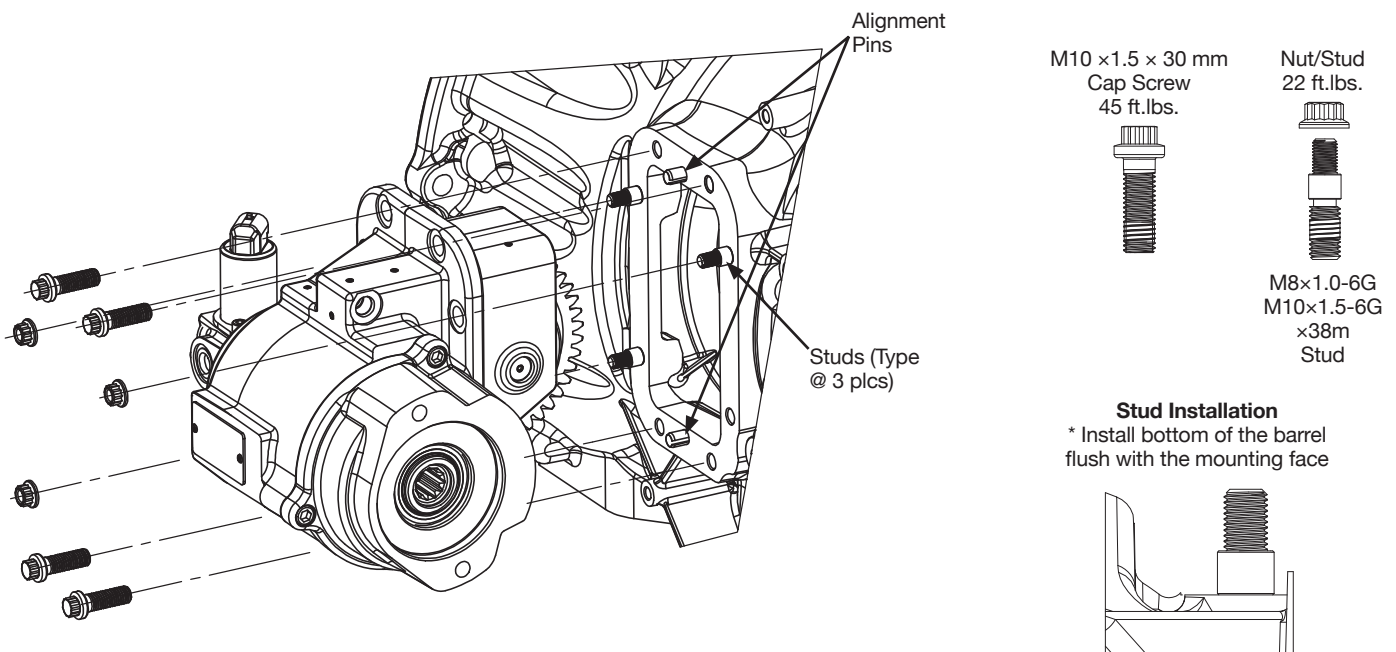

A Member of the Interpump Group

IN25-02 (Rev. 07-25)

201 East Jackson Street, Muncie, Indiana 47305
800-367-7867 • Fax: 765-284-6991 • info@munciepower.com

Specifications are subject to change without notice. Visit www.munciepower.com for warranties and literature. All rights reserved. © Muncie Power Products, Inc. (2025)

4. Retire la cubierta protectora y la junta de la PTO de la transmisión. **Precaución:** Se puede escapar algo de líquido de transmisión por la abertura. Tenga cuidado de evitar que entren contaminantes en la transmisión mientras la cubierta esté retirada. Verifique que el engranaje de la PTO esté presente en la transmisión. Identifique el kit de montaje de la PTO. Ubique los pasadores de alineación (2 unidades) y colóquelos en la ubicación correcta (ver más abajo).

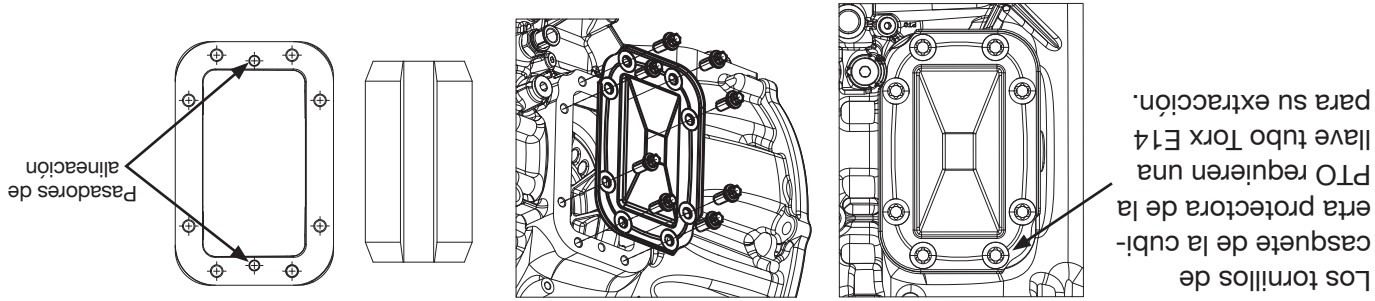

DESECHE LA JUNTA DE FABRICA.

NOTA: Antes de instalar la PTO, todo residuo y cualquier resto de aceite/líquido de transmisión debe limpiarse completamente de los orificios de los pernos de montaje de la PTO en la transmisión. El parche necesita un orificio limpio y seco para funcionar correctamente. Si no se limpian los orificios de los pernos, el parche no se activará.

5. Instale la junta suministrada sobre los pasadores de alineación. Se recomienda aplicar una capa delgada de líquido de transmisión aprobado sobre la junta para ayudar a mantenerla en la abertura. Monte la PTO con los tornillos de casquete, espárragos y tuercas incluidos. Verifique que la PTO encaje correctamente en la transmisión antes de apretar los sujetadores. ¡La superficie de montaje de la PTO debe estar alineada con la transmisión antes de apretar los sujetadores! De no hacerlo, podría ocasionar daños en la carcasa de la PTO. Ajuste primero los tornillos de casquete superiores e inferiores.

Instale lo siguiente: Junta (1 unidad), tornillos de casquete de 30 mm, espárragos y tuercas en las posiciones restantes (7 unidades). Los sujetadores incluidos tienen parches fijadores de roscas en las roscas. No se requiere el uso de fijador de roscas adicional.

