

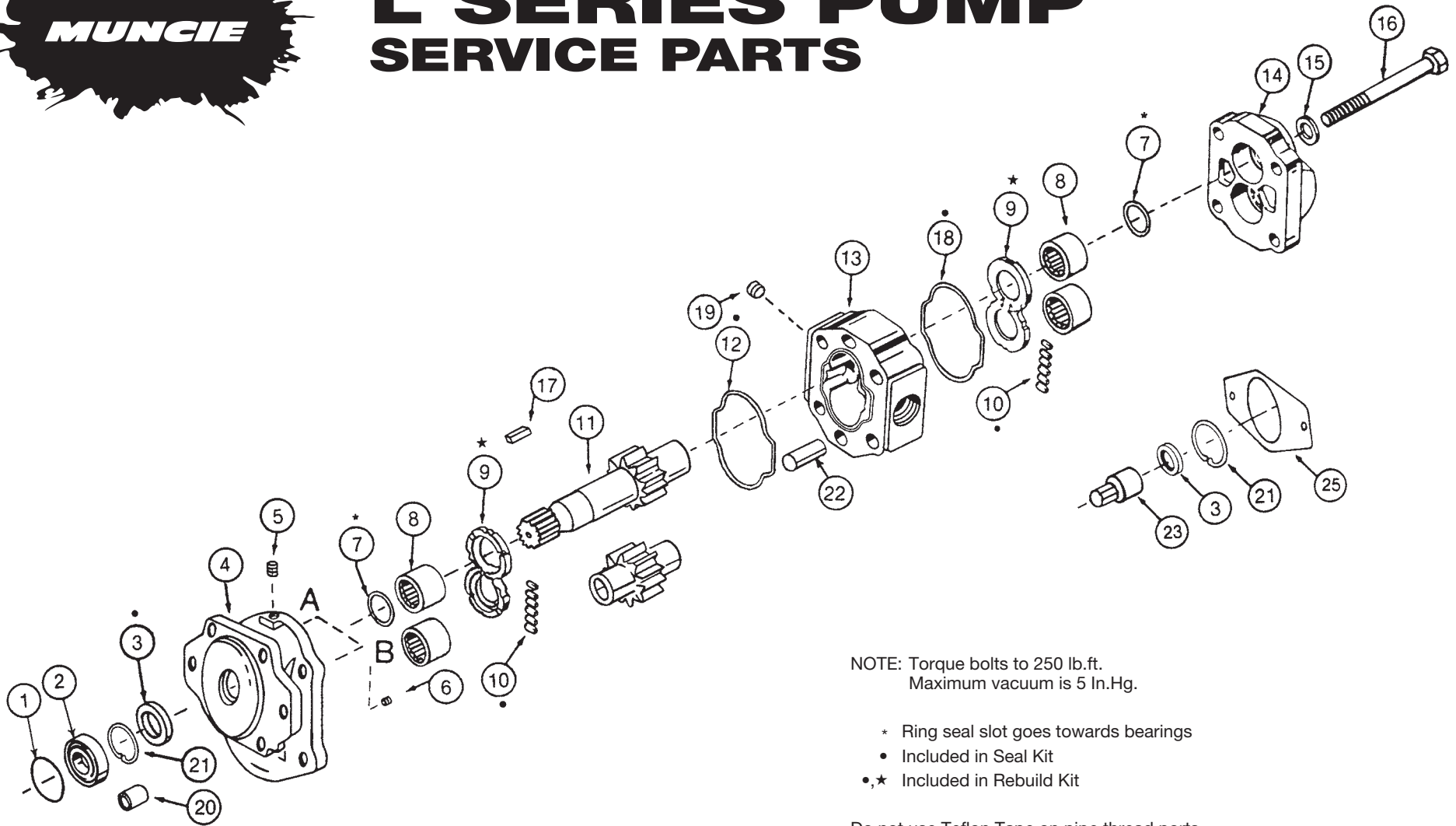

L SERIES PUMP SERVICE PARTS



NOTE: Torque bolts to 250 lb.ft.
Maximum vacuum is 5 In.Hg.

- * Ring seal slot goes towards bearings
- Included in Seal Kit
- ,* Included in Rebuild Kit

Do not use Teflon Tape on pipe thread ports.



SP89-04 (Rev. 10-04) Printed in the U.S.A.
© Muncie Power Products, Inc. 2004

Muncie Power Products, Inc. Member of the Interpump Hydraulics Group
General Offices and Distribution Center • P.O. Box 548 • Muncie, IN 47308-0548
(765) 284-7721 • FAX (765) 284-6991 • E-mail info@munciepower.com
Web site <http://www.munciepower.com>

Drive Products, Exclusive Agents for Canada, ISO Certified by an Accredited Registrar

L SERIES PUMP SERVICE PARTS

Item	Description	Qty	Muncie Number	Item	Description	Qty	Muncie Number
1	O.B. Snap Ring	1	PL-1001	13	Body (Pipe Ports)	1	
2	O.B. Bearing	1	PL-1002		14 GPM		PL-1025-14P
	Seal Retainer (without O.B. Bearing)	1	PE-1002D		16 GPM		PL-1025-16P
3	Shaft Seal	1	PL-1005		19 GPM		PL-1025-19P
4	Front Cover	1			23 GPM		PL-1025-23P
	SAE B Direct (Spline Shaft)		PL-1007-D		25 GPM		PL-1025-25P
	SAE B Direct (Rnd Shaft)		PL-1007-DOB		27 GPM		PL-1025-27P
	Remote Foot PAD		PL-1007-R		30 GPM		PL-1025-30P
	SAE C		PL-1007-DC				
	SAE B 4-Bolt		PL-1007-K				
5	Pipe Plug	1	HHPP-4		Body (ODT Ports)		
6	Check Assembly	2	PS-1010		14 GPM		PL-1025-14S
7	Ring Seal	2	PL-1008		16 GPM		PL-1025-16S
8	Bearings	4	PL-1013		19 GPM		PL-1025-19S
9	Wear Plates	2			23 GPM		PL-1025-23S
	Std		PL-1014		25 GPM		PL-1025-25S
10	Pocket Seal (12pcs)	1(3" strips)	PS-1009		27 GPM		PL-1025-27S
11	Gear Sets	1			30 GPM		PL-1025-30S
	7/8-13T Spline	14	PL-1016S-14-2	15	Washer	4	PL-1029
		16	PL-1016S-16-2	14	Rear Cover (NPT)	1	PL-1026P
		19	PL-1016S-19-2		Rear Cover (ODT)	1	PL-1026S
		23	PL-1016S-23-2		Machined For RV (NPT)		PL-1026-RV
		25	PL-1016S-25-2		Machined For RV (ODT)		PL-1026-RVS
		27	PL-1016S-27-2		Rear Cover (Versatile)	1	PL-1026TV
		30	PL-1016S-30-2	16	Capscrew/Stud	2 or 4/2	
	1 In. Round	14	PL-1016K-14-2		14 GPM		PL-1028-14/PL-1028-14S
		16	PL-1016K-16-2		16 GPM		PL-1028-16/PL-1028-16S
		19	PL-1016K-19-2		19 GPM		PL-1028-19/PL-1028-19S
		23	PL-1016K-23-2		23 GPM		PL-1028-23/PL-1028-23S
		25	PL-1016K-25-2		25 GPM		PL-1028-25/PL-1028-25S
		27	PL-1016K-27-2		27 GPM		PL-1028-27/PL-1028-27S
		30	PL-1016K-30-2		30 GPM		PL-1028-30/PL-1028-30S
	1 In. 15T Spline	14	PL-1016S17-14-2		N.S. Nut (direct only)		PE-1020
		16	PL-1016S17-16-2		Capscrew (Versatile)		
		19	PL-1016S17-19-2		14 GPM		PL-1028-294
		23	PL-1016S17-23-2		16 GPM		PL-1028-341
		25	PL-1016S17-25-2		19 GPM		PL-1028-295
		27	PL-1016S17-27-2		23 GPM		PL-1028-14
		30	PL-1016S17-30-2	17	Key	1	PS-1017
	1-1/4 In. Round	23	PL-1016K7-23-2	18	Body Seal	1	
		25	PL-1016K7-25-2		Rear Cover		PL-1015
		27	PL-1016K7-27-2	19	Port Plug	2	
11	Gear Sets (Versatile)	1			1 Inch (NPT)		HHPP-16
	7/8-13T Spline	14	PL-1016S-14-2TV		1-1/4 Inch (NPT)		HHPP-20
		16	PL-1016S-16-2TV		1-1/2 Inch (NPT)		HHPP-24
		19	PL-1016S-19-2TV		-16 (ODT)		HHBP-16
		23	PL-1016S-23-2TV		-20 (ODT)		HHBP-20
	1 In. Round	14	PL-1016K-14-2TV		-24 (ODT)		HHBP-24
		16	PL-1016K-16-2TV	20	Seal Retainer (with O.B. Bearing)	1	PL-1003
		19	PL-1016K-19-2TV	21	Seal Snap Ring	1 or 2	PL-1004
		23	PL-1016K-23-2TV	22	Dowell Pin	4	PL-1024
12	Body Seal Front Cover	1	PL-1012	23	Connection Shaft	1	PL-1033TV
				25	Rear Flange Gasket	1	PL1032TV
				N.S.	Relief Valve Cartridge	1	1224V-1
					Seal & O-Ring Kit		GSKPL-2
					Rebuild Kit		RBKPL-2
					Bearing Kit		PL-1013-K